



NUSANTARA

# Nusantara: Towards Vision 2045

**Silvia Halim**

Deputy for Facilities and Infrastructure  
Nusantara Capital Authority

Woman in Rail Conference  
Kuala Lumpur, 3<sup>rd</sup> August 2023



# President Jokowi launches final phase of 2025-2045 National Long-Term Development Plan



Image: thejakartapost



The President emphasized three crucial points for Indonesia's development: **nation stability, sustainability / continuity, and skilled human capital.**



Jokowi also said significant change was possible as long as **"we have the courage, determination, will and hard work to make the big [leap]. This is what we need".**



# Nusantara and the Nation's 2045 Vision | from reformative to transformative, through four areas of change



## Human Development and Mastery of Scientific and Technological Skill

Building world-class talent with a solid basis in the digital and educational ecosystems.



## Sustainable Economic Development

Enhance East Kalimantan's GDP by threefold by 2045 through transforming the economy from resource-dependent to more diverse.



## Strengthening national resilience and governance

Capability of establishing specific standards for regulatory frameworks driven by investment and innovation.



## Equitable development

Strategically located to promote GDRP growth in Eastern Indonesia and to boost the local economic value chain as a whole.

# Nusantara | Indonesia's Active Contribution to Global Campaign

## Biodiversity



Protecting and conserving the Nusantara's biodiversity including those that are endangered through Nusantara Nature Positive Plan to ensure wildlife habitat's existence and security

## Climate Change



Nusantara is Indonesia's first city that declares its Locally Determined Contribution (LDC) and it is instrumental in ensuring its carbon-neutral goal by 2045 and helping to deliver national climate change targets.

## Sustainable Development Goals



Nusantara will have its own Voluntary Local Review (VLR) to track SDGs achievements at local level, and accelerate the attainment of UN 2030 Sustainable Development Agenda.

# Nusantara | Indonesia's new capital city

*Nusantara allows investment opportunities and positively impacts Indonesia's development.*



Nusantara to promote economic equity and social development  
*“World-class city for all”*

## Nusantara Vision



*The World's Sustainable City*



*A Symbol of National Identity*

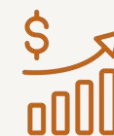

*Economic Driver for Indonesia's Future*

## Nusantara Highlights

**Location:**

**East Kalimantan, Indonesia<sup>1</sup>**

**Area:**

**256.142 ha**

Divided into 3 zone<sup>2</sup>

**Population<sup>3</sup>**

**4 – 5 Mn**

All tri-cities Population<sup>3</sup>

**Governance:**



**NUSANTARA**  
 Otorita Ibu Kota Nusantara<sup>4</sup> (OIKN)

**Investment Needs:**

**USD 32 Bn**

In terms of infrastructural and economic influences (technology, renewable energy, electric vehicles, and so on),

Sources: Wiki "ID Country"; Wiki "Economy of ID"; 1. Berlokasi di antara kota Balikpapan dan Samarinda (2 kota besar di provinsi Kalimantan bagian Timur); 2. KIPP (6,6k ha), K-IKN (56k ha), KP-IKN (256k ha); 3. Balikpapan, Samarinda dan Nusantara; 4. OIKN, Otorita Ibu Kota Nusantara sebuah badan pemerintahan yang bertugas untuk membangun Nusantara, dibentuk melalui PP No.3 / 2022; 5. 20% dari APBN, 80% dari investasi swasta.

# Tri-city economy | Future Economic Superhub of Indonesia

A more inclusive and equitable economic growth will be leveraged by the development of IKN as an economic Superhub, which will be an integral part of efforts to transform the economy in the Capital City of the Archipelago and East Kalimantan Province as well as Partner Regions on Kalimantan Island.

The presence of the IKN economic superhub is expected to provide benefits to Partner Regions on Kalimantan Island in the form of conducive ecosystem development and economic clusters that will become new sources of growth on Kalimantan Island.

## Three Cities cooperation strategy

### Upstream Agriculture and Nature Tourism Center

- Development of nature tourism and wellness tourism
- Development of upstream agricultural production connected with the downstream agri-industrial sector

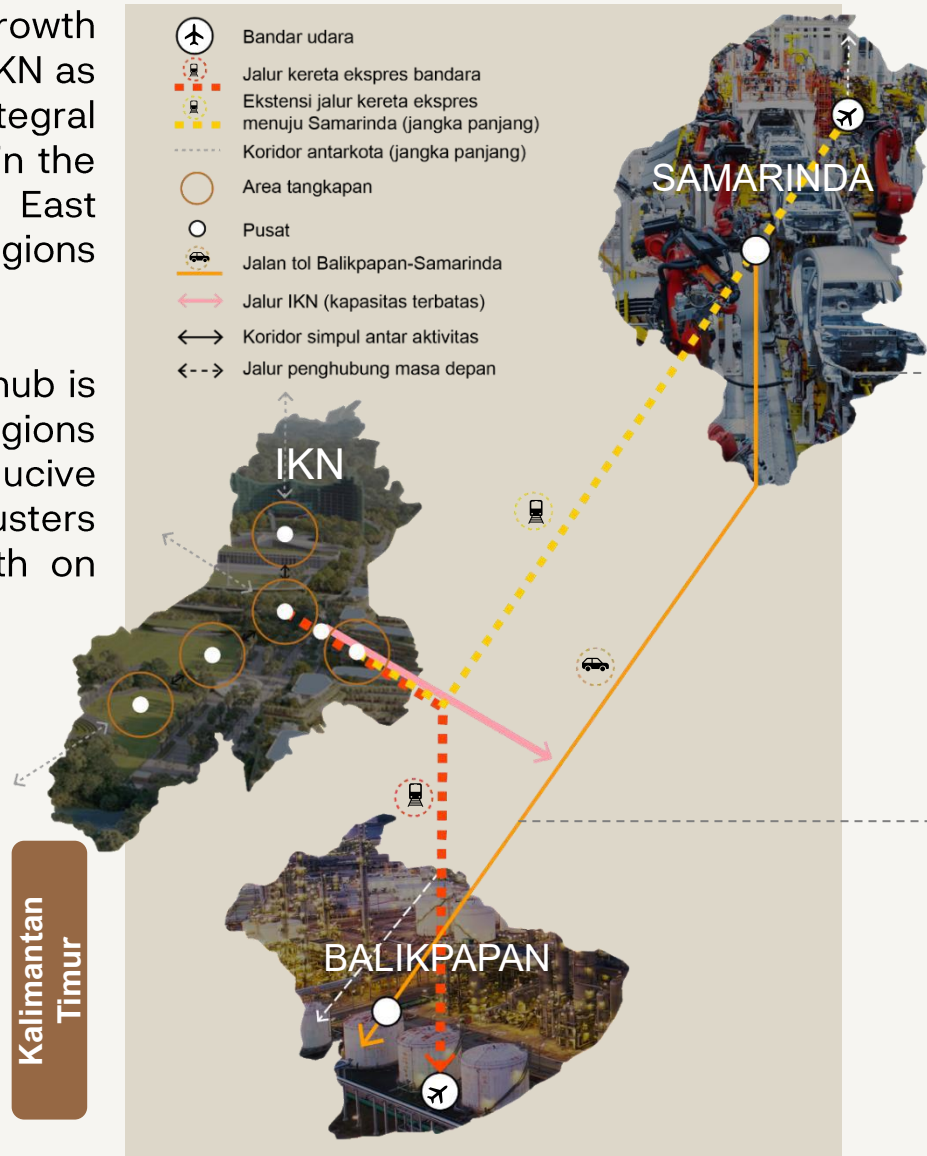

### Samarinda

#### Historical center of East Kalimantan with a rejuvenated energy sector

- The administrative center for East Kalimantan
- A lighthouse for sustainable coal mining
- New manufacturing base for renewable energy

### IKN

#### Government core and green innovation center for the region

- Government and community service center
- Innovation center and talent center
- Clean and high-tech industry
- Base for tourism for the region

### Balikpapan

#### Oil and gas and logistics downstream node for East Kalimantan

- Downstream processing of oil & gas industry into petrochemicals
- The main seaport for the province and region

# Development Areas | Nusantara's 9 Economic Generators

- 1 Core Government Area**  
KIPP – 6,671 Ha
- 2 Economic and Financial Center**  
West IKN – 17,206 Ha
- 3 Renewable Energy Area**  
South IKN – 6,753 Ha
- 4 Tourism and Leisure**  
East IKN 1 – 9,761 Ha
- 5 Education Services**  
North IKN – 12,067 Ha
- 6 Innovation and Research**  
East IKN 2 – 3,720 Ha
- 7 Agro-commodities, Trade & Logistics**  
Simpang Samboja – 2,986 Ha
- 8 Agriculture Industry**  
Kuala Samboja – 4,299 Ha
- 9 Fisheries and Agricultural**  
Muara Jawa – 9,084 Ha

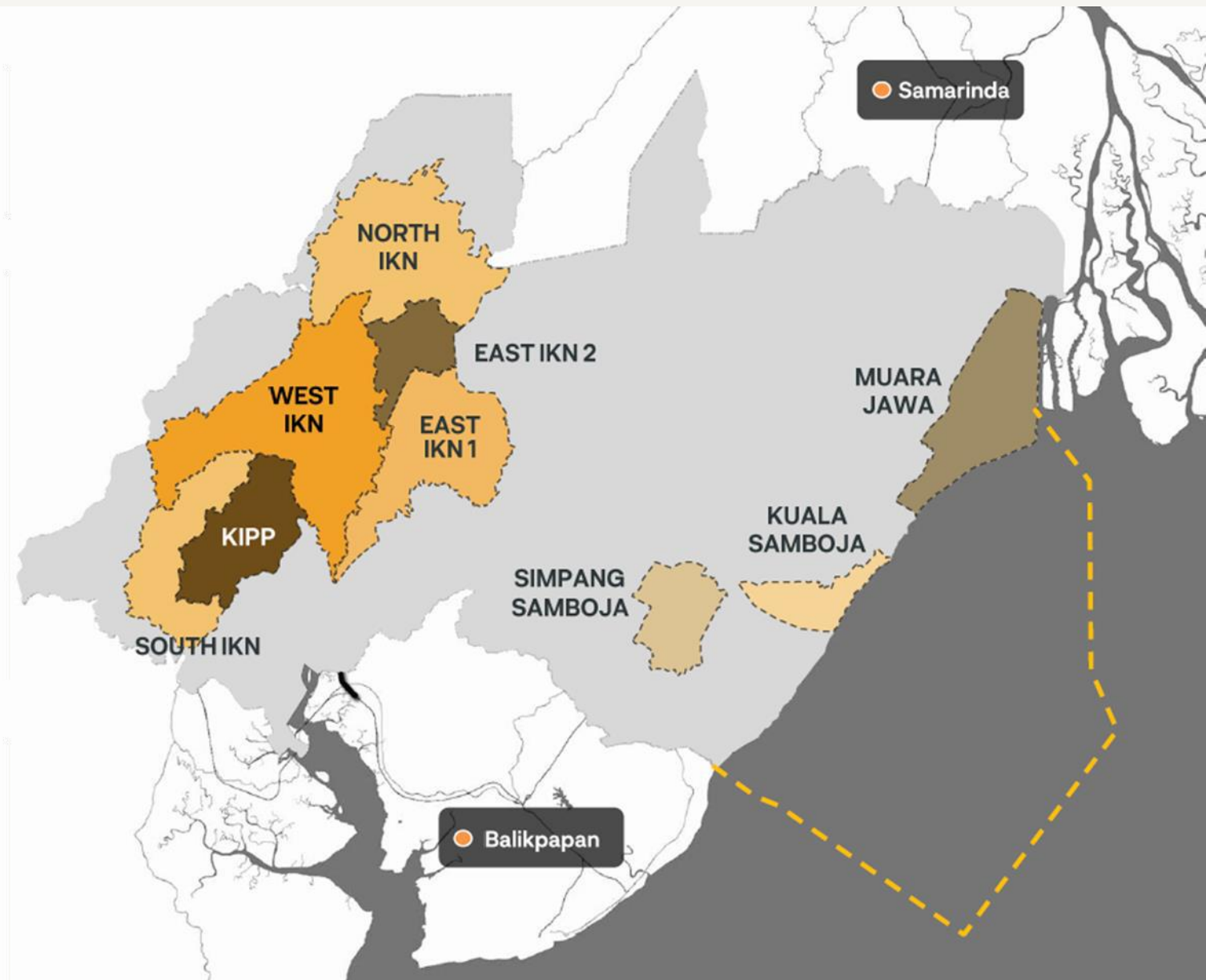

# Nusantara | Expected to have ~0.3 Mn population by 2024, and continuously grow by 65% growth rate until 2045

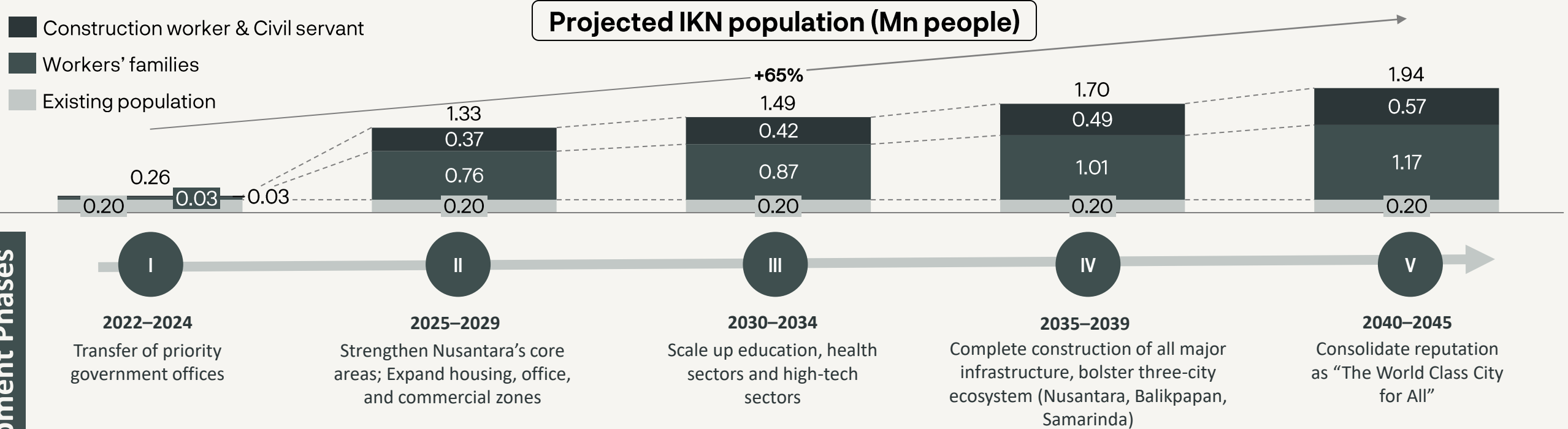

Nusantara’s Development Phases

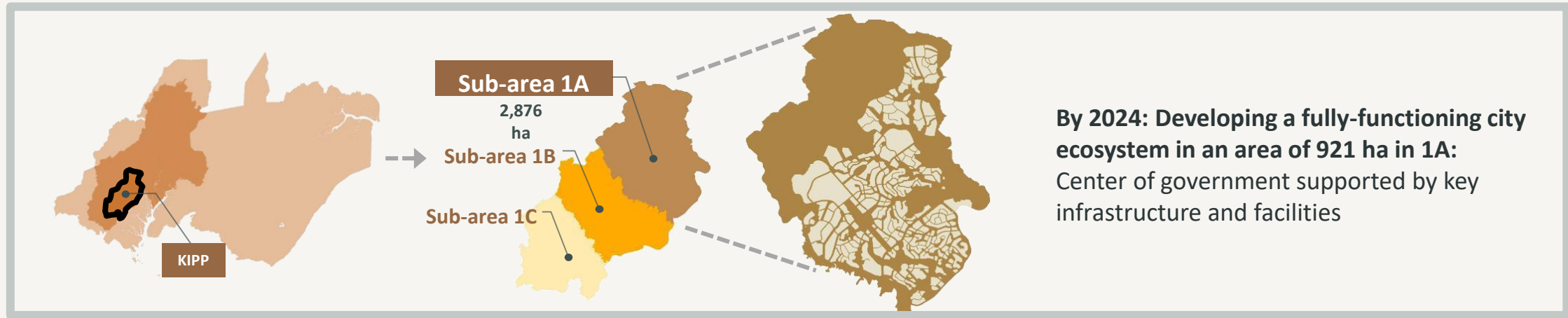



# Strong and formidable progress | Nusantara development has outperformed planned progress across priority sectors being developed

Overall: 37.43 %

Presidential Palace & Ceremonial Field



Sepaku Semoi Dam



Kebangsaan Axis



20.49%



92.77%



41.44%





## Nusantara | 8 Principles and 24 Key Performance Indicator

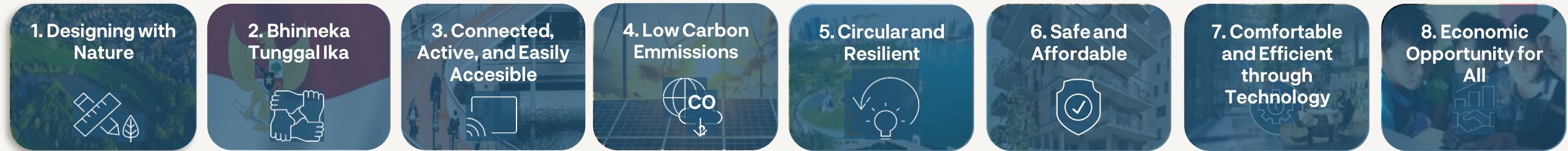

**1.1** **>75%** from 256K Ha Areas for green space (65% protected area and 10% food production)

**2.1** **100%** Integration of the entire population - existing and new ones

**3.1** **80%** of travel with public transportation or active mobility

**4.1** Renewable energy capacity installation will meet **100%** of IKN energy needs

**5.1** **>10%** from 256k Ha land available for food production needs

**6.1** **Top-10 EIU Liveable City** in the world by 2045

**7.1** Achieving a **very high** ranking in E-Government Development Index (EGDI) from UN

**8.1** **0%** poverty in the IKN population in 2035

**1.2** **100%** Residents can access recreational green space in 10 minutes

**2.2** **100%** Residents can access social / community services within 10 minutes

**3.2** **10 minutes** travel to important facilities and public transportation nodes

**4.2** **60%** energy savings from energy conservation in the building

**5.2** **60%** waste generation Recycled in 2045

**6.2** Existing and planned settlements in the 256K area **have access to important infrastructure** by 2045

**7.2** **100%** digital and ICT connectivity for all residents and business

**8.2** **GDP per capita** of a high -income country

**1.3** **100%** Rehabilitation of green space for each institutional, commercial, and residential multi - store building (building > 4 floors)

**2.3** **100%** Public spaces are designed using the principles of universal access, local wisdom and inclusive design

**3.3** **<50 minutes** Transit express connection from KIPP to strategic airport in 2030

**4.3** **Net zero emission** for IKN (when operating) in 2045 in the 256K Ha area

**5.3** **100%** Wastewater processed through a processing system in 2035

**6.3** **Fair housing with a ratio of 1: 3: 6** for luxury, middle, and basic types

**7.3** **>75%** Business satisfaction with Digital Services ranking

**8.3** Lowest regional **Gini Ratio** in Indonesia by 2045



# Nusantara | Sustainable and Resilient Forest City



10%

Green Areas and Food Production

65%

Tropical Forest through Reforestation

25%

Urban Built Area

Target: Carbon neutral city by 2045

## First Indonesia's city to implement ESG standards

Environment, Social, and Governance



Sponge City:  
Urban Design to  
reduce water  
runoff

## Nusantara | Green and Smart City

### 1 Governance

- Digital Identification
- Data Exchange Layer
- Application's Layer

### 2 Transportation & Mobility

- Intelligent Transport System
- City Logistic

### 3 Living

- Pollution Control System
- Public Space and Safety System
- Health and Welfare System
- Disaster Response and Management

### 4 Natural Resources & Energy

- Smart Resource and Energy Management
- Smart Forest and Green Management

### 5 Industry & Human Resources

- SMEs Platform
- Urban Citizen Living Lab
- Technological Center
- Industries (Pharmacy, Machinery, Chemical)
- Smart Education
- Smart Tourism
- Digital Social Platform and Citizen Service Collaboration

### 6 Built Environment & Infrastructure

- 5G Infrastructure
- Smart Infrastructure
- Smart Building
- Social Facilities, Commercial Facilities
- Smart Utilities



GREENSHIP

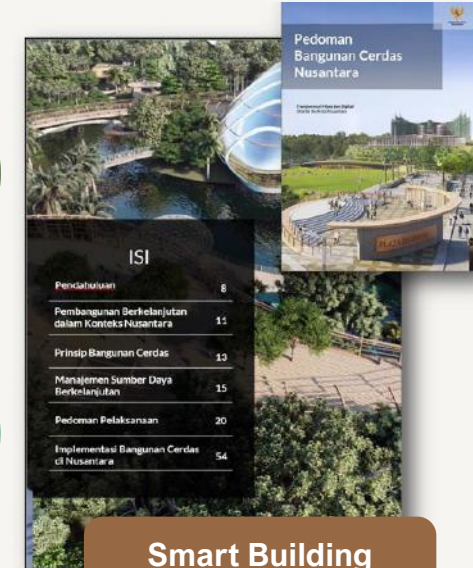

Smart Building Guidelines

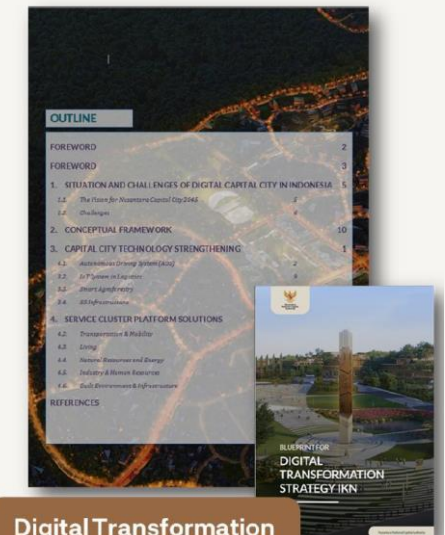

Digital Transformation Strategy - Blueprint

# Nusantara | 80% Public Transportation and Active Mobility

Tol Balikpapan-Samarinda

To support the development of Nusantara,  
The transportation sectors carries out optimization nodes and networks planning:

- Bus Rapid Transit Systems
- Bus Networks
- Airport Line Balikpapan – Nusantara
- Inter Cities Railway Network
- Urban Metro Systems
- Micro Mobility Networks

-  SAMS Sepinggan BPN Airport
-  APT Pranoto Airport
-  VVIP Airport Plan / Kemenhub
-  Jaringan Jalur Kereta Api Perkotaan IKN
-  Jaringan Jalur Kereta Api Antarkota
-  Jaringan Jalur Kereta Api Bandara
-  Jaringan Jalur Kereta Api Perkotaan
-  Stasiun Operasi
-  Stasiun Penumpang
-  Pelabuhan Semayang
-  Pelabuhan Kuala Samboja
-  Pelabuhan Kariangau
-  Pelabuhan Handil II
-  Rencana Dermaga Wisata
-  Terminal Penumpang Tipe A
-  Terminal Penumpang Tipe B
- Faspim Transfer Point**
-  Titik Nol IKN
-  Temporary Transfer Point
-  Transfer Centre KIPP IKN 1A-1
-  Jalan Tol
-  Jalan Arteri Primer

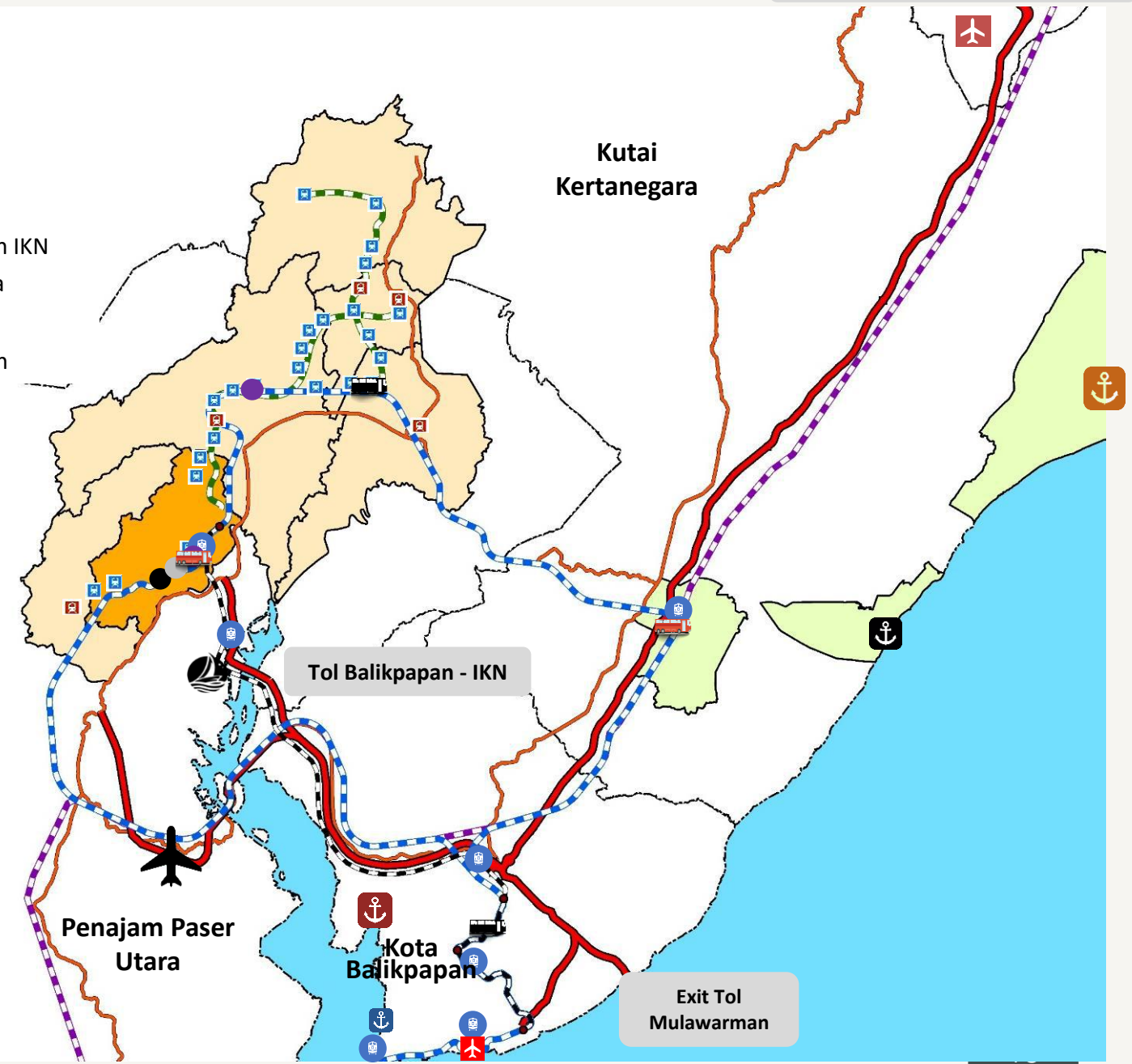

# Nusantara Knowledge Journey | International Collaboration (Selected)

MoU with Shenzhen City, China



Cooperate to exchange information and to boost investment between Shenzhen and Nusantara

MoU with Astana, Kazakhstan



Launched a sister city agreement with Astana's capital city

MoU with CLC, Singapore



Nusantara Capital City and the Singapore Ministry of National Development's Center for Liveable Cities (CLC) are working together to establish livable and sustainable cities at Nusantara.

# LoI | Considerable Letter of Intent from potential Investors have been received, amounting to 200+ LOIs per mid Jun '23

Total Letter of Intent received (# LoI)

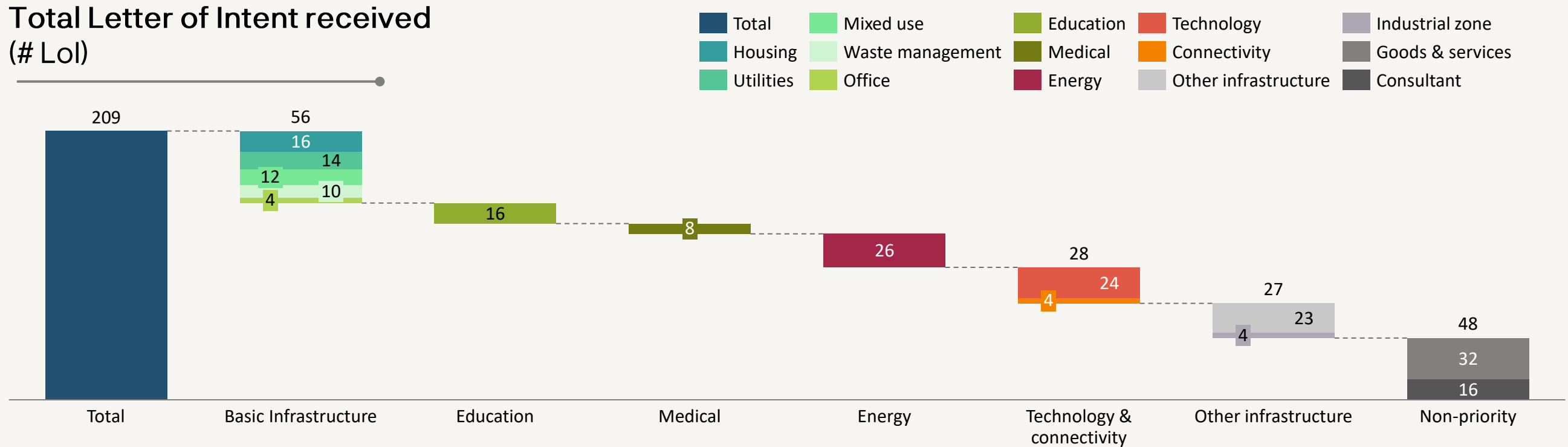

## Top contributing countries per mid Jun 2023



**25 LOIs**



**24 LOIs**



**16 LOIs**



**15 LOIs**



**6 LOIs**

# Modality | Nusantara provides huge opportunities for investors to contribute, totaling to USD 25,8 Bn of investment opportunities

Nusantara Development's Modality Schemes (Bn USD)

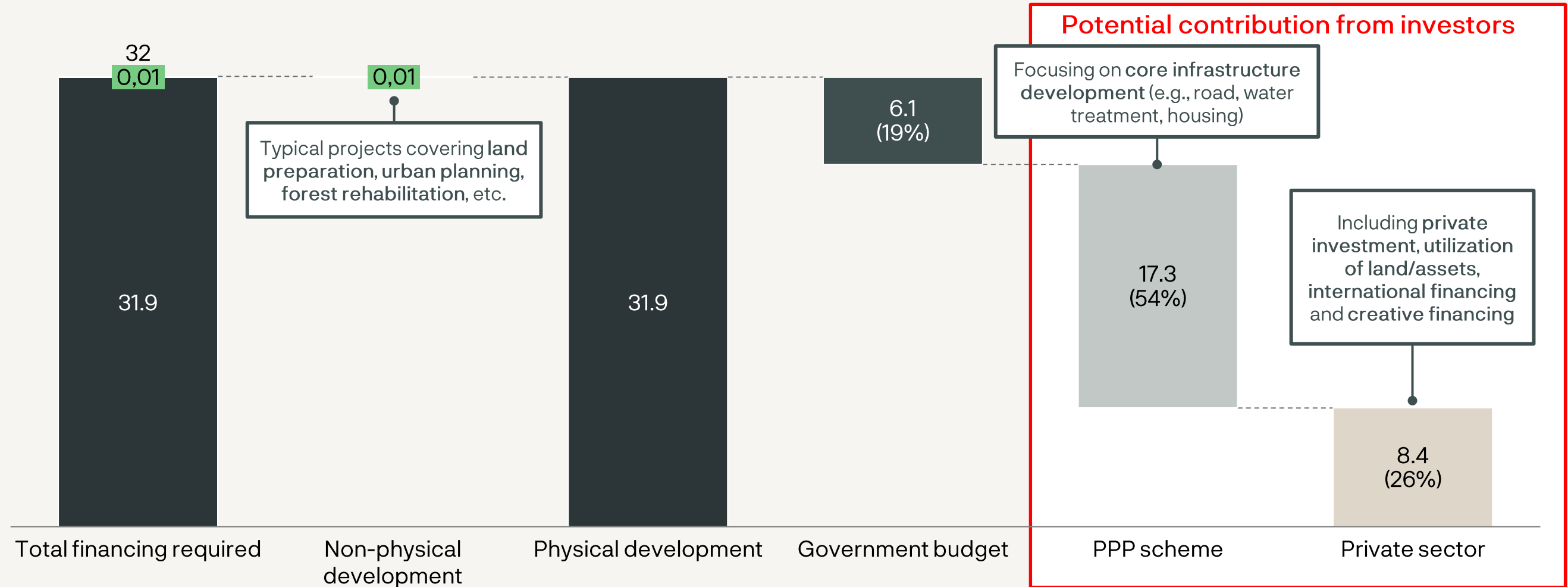



# Nusantara

## August 2024

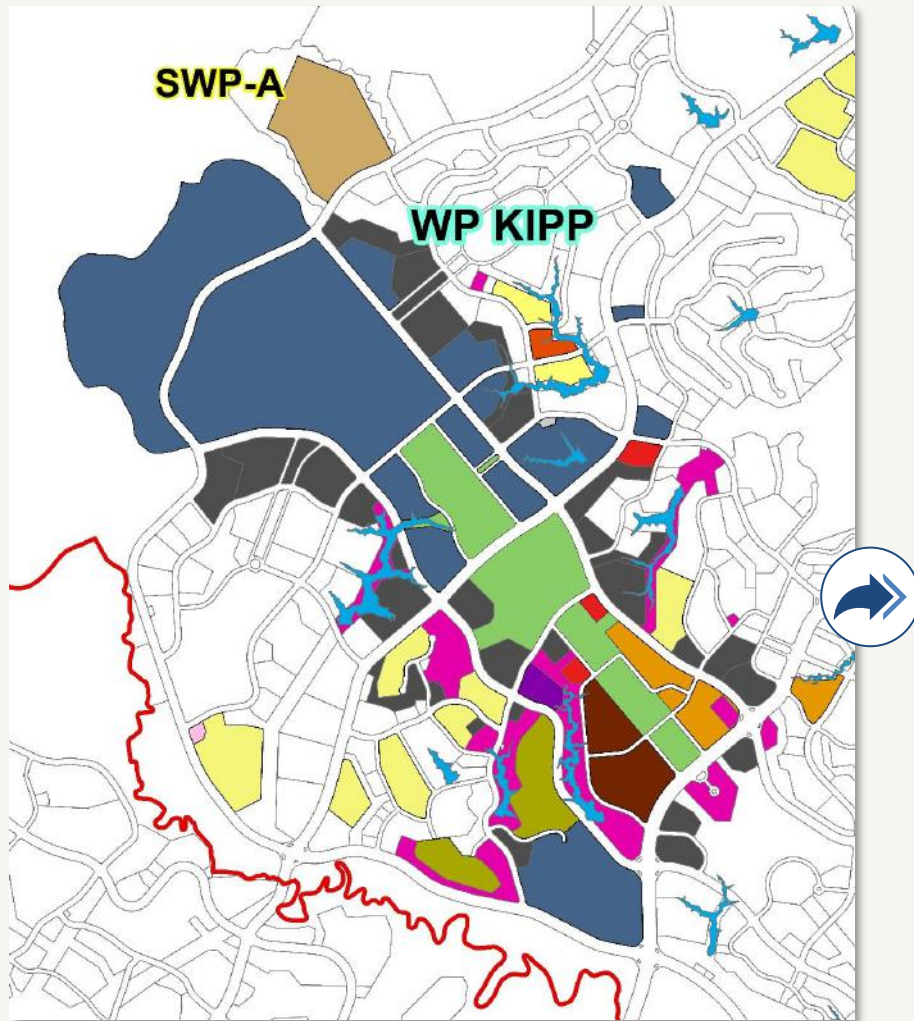

Total development area  
**542,7 Ha**

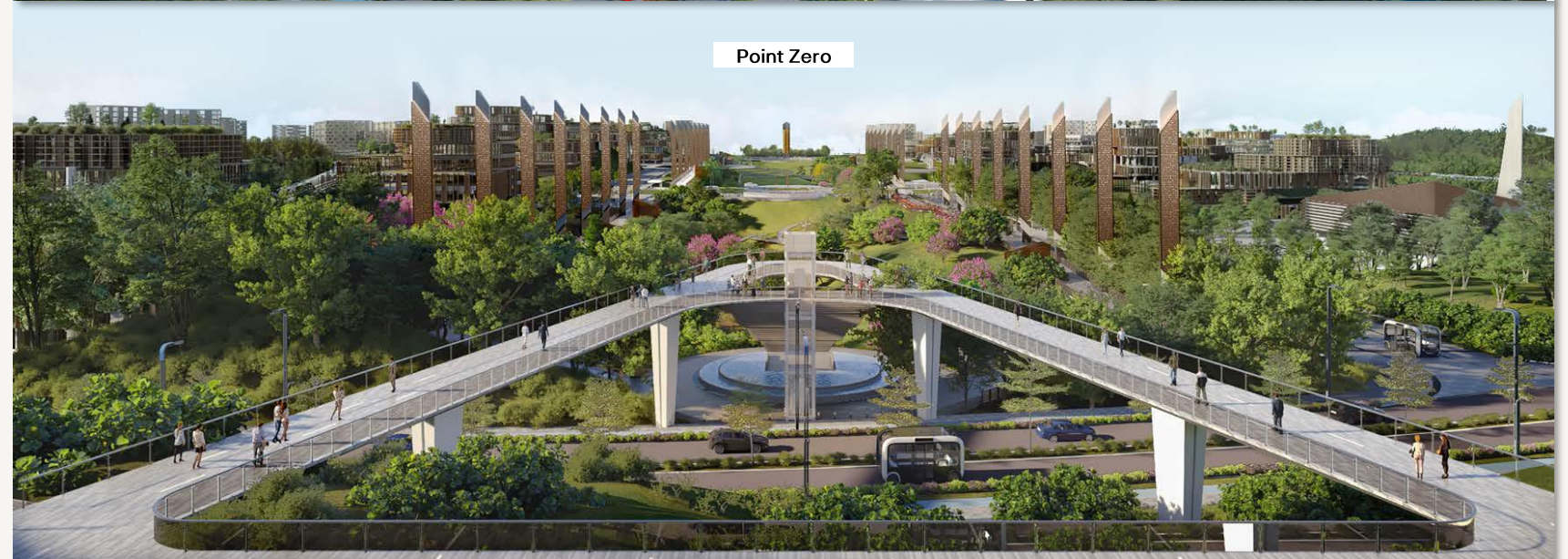



**Nusantara  
Capital Authority**



**Nusantara National Capital Authority – Jakarta  
Office**

Menara Mandiri Tower II, Floor 27  
Jl. Jend. Sudirman Kav 54-55, RT.5/RW.3, Senayan,  
Kebayoran Baru, Jakarta Selatan 12190, Indonesia

**Nusantara National Capital Authority – Balikpapan  
Office**

Pantai Mentari Compound  
Jl. Mulawarman 6, Manggar, Kec. Balikpapan Timur  
Kota Balikpapan 76116, Kalimantan Timur

Office +62 21 27099100  
Email [investasi@ikn.go.id](mailto:investasi@ikn.go.id)  
[sekretariat@ikn.go.id](mailto:sekretariat@ikn.go.id)

Website [ikn.go.id](http://ikn.go.id)  
Youtube [IKN Indonesia](https://www.youtube.com/IKNIndonesia)  
Instagram [@ikn\\_id](https://www.instagram.com/ikn_id)  
Twitter [@ikn\\_id](https://twitter.com/ikn_id)  
Facebook [IKN Indonesia](https://www.facebook.com/IKNIndonesia)